

THE TOOLING YOU NEED WITH WILSON TOOL BENEFITS

Wilson Tool International Fixed Height tooling is optimized for performance and ease of use. All tooling is Nitrex® heat treated to 70HRC for increased strength, durability and lubricity. This ensures longer life and better performance. Each section is matrix coded and tooling detail appears in easy-to-read laser marking.

Wilson Tool International's Fixed Height line is fully compatible with Amada® machines. It is made in and shipped from the USA with the shortest lead-times available.

The Customization You Require

As with all Wilson Tool press brake tool styles, Fixed Height tooling can be custom made in special configurations for unique bends. Special tip modifications and cuts are designed and manufactured out of our Minnesota headquarters. We have a team of technically trained sales engineers, application specialists and designers who can help you to identify the ideal Fixed Height tool for your application.

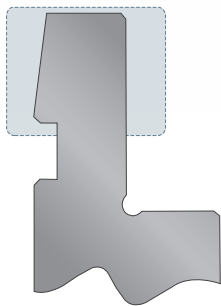

SECTIONALIZED PUNCH LENGTHS:

L = 32.87" [835mm]

S = 20.08" [510mm]

X = 14.6" [370mm]

X Section Lengths [mm]: 10 (2) | 15 | 20 | 25 | 40 | 50 | 100 Ear Sections (2)

100 = 3.93" [100mm]

Featuring the beveled punch tang.



Amada® is a registered trademark of Amada Co., Ltd. and is used by Amada America, Inc., Amada Capital Corporation and Amada Co., Ltd.

120MM TALL PUNCHES

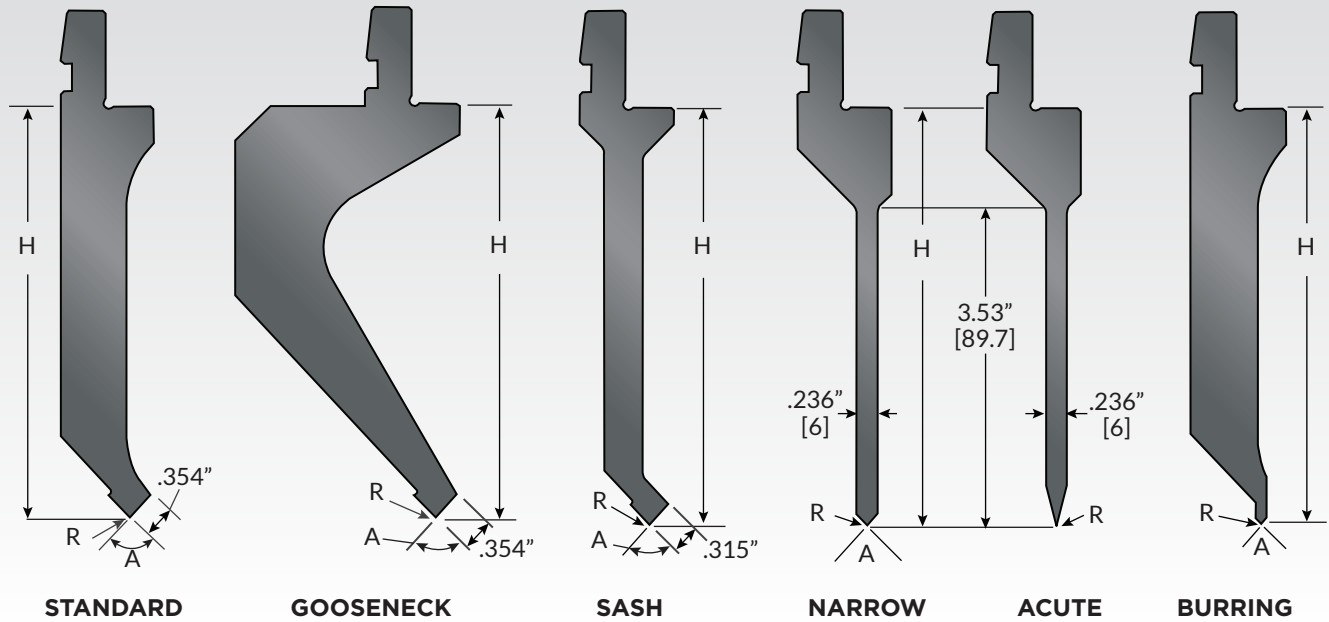

120MM TALL FIXED HEIGHT TOOLING WITH BEVELED TANG										
PUNCH STYLE	CAT. NO.	ANGLE	TIP RADIUS inch [mm]	HEIGHT inch [mm]	MAX TON L & S ft [meter]	MAX TON X ft [meter]	L	S	X	100
STANDARD	A0402	86°	.008 [0.2]	4.724 [120]	30 [100]	12 [40]				
	A0406		.024 [0.6]	4.717 [119.8]						
	A1602	M	90°	.008 [0.2]						
GOOSENECK	A4702	86°	.008 [0.2]	4.724 [120]	30 [100]	12 [40]				
	A4706		.024 [0.6]	4.717 [119.8]						
	A4802	M	90°	.008 [0.2]						
SASH	A2002	86°	.008 [0.2]	4.724 [120]	15 [50]	7 [23]				
	A2006		.024 [0.6]	4.717 [119.8]						
	A2102	M	90°	.008 [0.2]						
NARROW	A1902	86°	.008 [0.2]	4.724 [120]	15 [50]	7 [23]				
	A1906		.024 [0.6]	4.717 [119.8]						
	A1802	M	90°	.008 [0.2]						
ACUTE	A1302	30°	.008 [0.2]	4.724 [120]	15 [50]	7 [23]				
	A1306		.024 [0.6]	4.717 [119.8]						
BURRING	A0502	86°	.008 [0.2]	4.724 [120]	15 [50]	7 [23]				
	A0506		.024 [0.6]	4.717 [119.8]						
	A1702	M	90°	.008 [0.2]						

M Made To Order

ACUTE AND BLOCK DIES

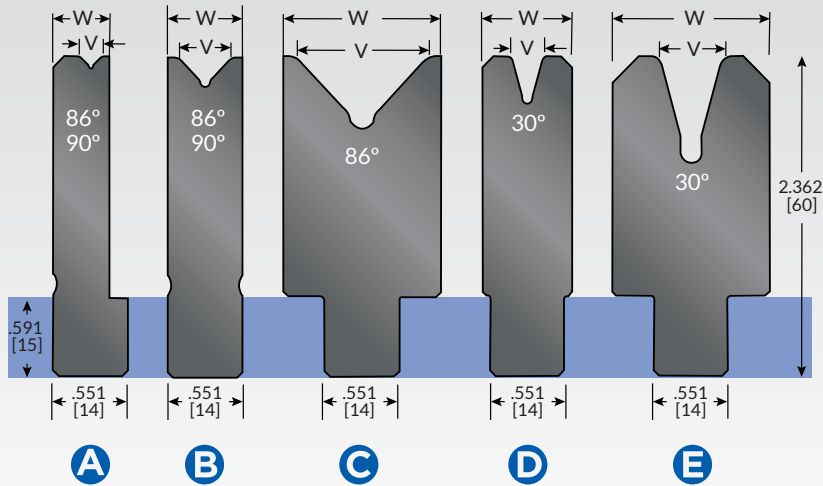

SECTIONALIZED PUNCH LENGTHS:

L = 32.87" [835mm]

S = 20.08" [510mm]

X = 14.6" [370mm]

X Section Lengths [mm]:

10 (2) | 15 | 20 | 25 | 40 | 50 | 100

Ear Sections (2)

100 = 3.93" [100mm]

86°, 84° AND 90° FIXED HEIGHT DIE

CAT. NO.	ANGLE	V Opening inch [mm]	W Width inch [mm]	Max Ton L, S, X	L	S	X	100
A A8406	86°	.157 [4]	10.0	26 [87]				
A A8506		.197 [5]	10.5					
A A7006		.236 [6]	11.0					
A A8606		.276 [7]	11.5	29 [97]				
A A7106		.315 [8]	12.0					
B A7206		.394 [10]	14.0					
B A7406		.472 [12]	16.0					
B A7606		.551 [14]	18.0					
B A7706		.630 [16]	20.0					
B A7806		.709 [18]	22.0	30 [100]				
B A7906		.787 [20]	24.4					
C A8206		.984 [25]	29.5					
A A8409	M	.157 [4]	10.5	26 [87]				
A A8509	M	.197 [5]	11.0					
A A7009	M	.236 [6]	11.5					
A A8609	M	.276 [7]	12.0	29 [97]				
A A7109	M	.315 [8]	12.5					
B A7209	M	.394 [10]	14.0					
B A7409	M	.472 [12]	16.0	30 [100]				

30° FIXED HEIGHT DIE

CAT. NO.	ANGLE	V OPENING inch [mm]	W WIDTH inch [mm]	MAX TON L, S, X	L	S	X	100
D A8403	30°	.157 [4]	14.0	5 [17]				
D A7003		.236 [6]	17.0	6 [20]				
D A7103		.315 [8]	20.0					
E A7403		.472 [12]	30.0	9 [30]				

M Made To Order

85MM TALL PUNCHES

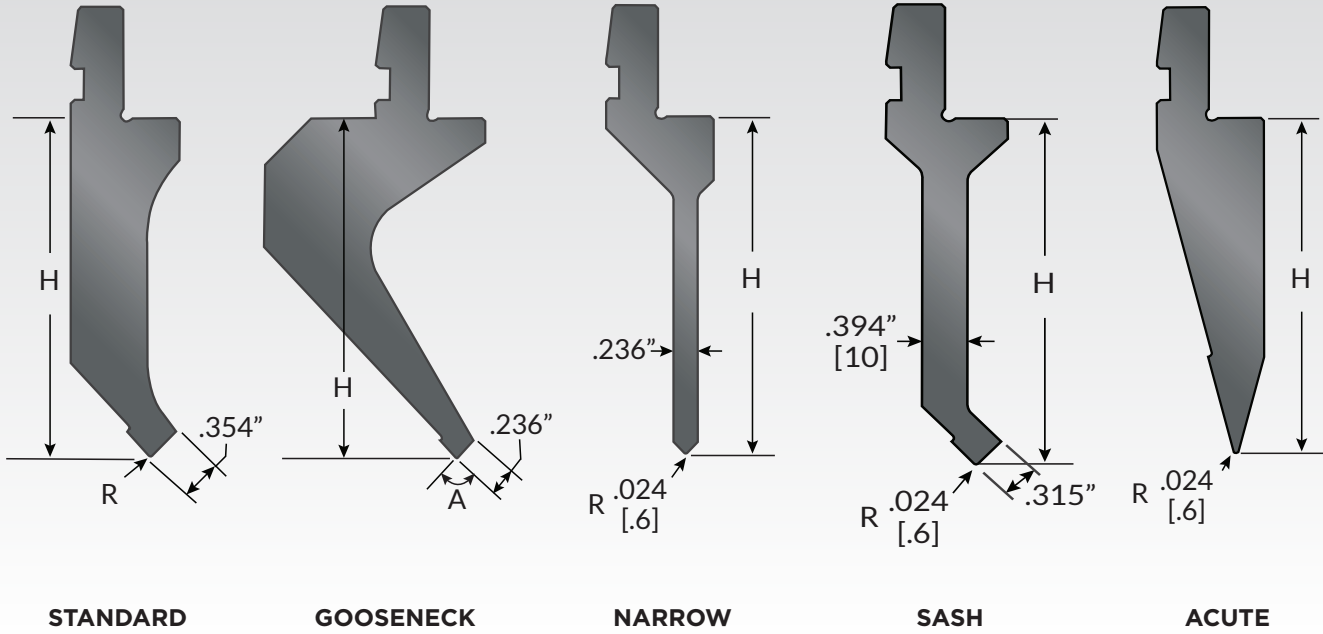

85MM TALL FIXED HEIGHT TOOLING WITH BEVELED TANG											
PUNCH STYLE	CAT. NO.	ANGLE	TIP RADIUS inch [mm]	HEIGHT inch [mm]	MAX TON L & S ft [meter]	MAX TON X ft [meter]	L	S	X	100	
STANDARD	A1406	M			30 [100]	14 [47]					
GOOSENECK	A4306	M	.024 [0.6]	3.339 [84.8]	21 [70]	14 [47]					
NARROW	A2906	M			15 [50]	3.7 [12]					
SASH	A1006	M			9 [30]	5 [17]					
ACUTE	A2306	M			30°		30 [100]	9 [30]			

M Made To Order

For more information, visit wilsontool.com, call our tooling technicians at 800-445-4518 or contact your sales engineer.

© 2020 Wilson Tool International. All rights reserved. B343F (8.2020)